

Section 10

Smart Wired



Harmony™ Range kits and modules



Pack	Cat No.	Packaged kits
1	SWMK01	Start up communication package. Includes essential phone distributor, video amplifier, video combiner and splitter & small enclosure
1	SWMK02	Entertainment package. Includes advanced phone distributor, video amplifier, advanced video combiner and splitter, network patch panel & medium enclosure
1	SWMK03	Total control package. Includes advanced phone distributor, video amplifier, advanced video combiner and splitter, 2 network patch panels & large enclosure

Pack	Cat No.	Video (TV) combiner and splitters
1	SWWCS01	Digital picture ready. RG6 quad shielded coax cable. Video combiner and splitter. 2 RF inputs. 6 outputs. Accepts F type connectors. Video amplifier SWVA01 recommended.
1	SWAVCS01	Advanced video combiner and splitter. 4 RF inputs, 8 outputs. Accepts F type connectors. Video amplifier SWVA01 recommended.
1	SWVA01	Video amplifier. Amplifies video (TV) signal before distribution through-out system. 12V dc at 100mA. Requires power supply - SWPS005, SWPS030 or SWPS050



Pack	Cat No.	Harmony enclosures
1	SWME01	Small metal enclosure. Surface mount only. Base 360 x 180 x 10mm. Cover 372 x 184 x 110mm.
1	SWME02	Medium metal enclosure. Surface or cavity mount. Base 380 x 380 x 98mm. Cover 410 x 410 x 15mm.
1	SWME03	Large metal enclosure. Surface or cavity mount. Base 700 x 380 x 98mm. Cover 730 x 410 x 15mm.

Pack	Cat No.	Network (Cat 5E)
1	SWDH05	Network data hub. 5 x 10/100 Mbps. RJ45 ports. 1 uplink for expansion. Power supply included.
1	SWPP08	Network patch panel. 8 x RJ45 sockets with corresponding IDC connectors.

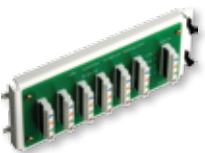

Pack	Cat No.	Telephone distributors
1	SWETD01	Essential telephone distributor. Punchdown IDC distributor. 4 line inputs. Up to 6 telephone outlets per input line.
1	SWATD01	Advanced telephone distributor. 4 line IDC input. Up to 6 RJ45 outputs per input line. Dedicated RJ31X connector. Connects to network patch panel (SWPP08) via patch leads (SWLD003 & SWLT003).

Pack	Cat No.	Infra-red
1	SWIRE22	Infra-red emitter. Connects with RJ45 plug. Emits IR signal to control device. 2 x IR LED. Distributes IR signal via Cat 5E cable
1	SWIRM44	Infra-red distributor. Supports up to 4 IR control sets (emitters & receivers). 12V d.c. at 1A. Requires power supply.
1	SWIRR02	Infra-red receiver. Connects with RJ45 plug. Receives IR signal to send to device requiring controlling via infra-red distributor.



Pack	Cat No	Distributed audio
1	SWSPK01	Pair of ceiling mount stereo speakers, 230mm diameter x 90mm depth, 30W RMS
1	SWSPK02	Sum adding mono speaker, 230mm diameter x 90mm depth, 30W RMS
1	SWSPK03	Pair of ceiling/wall mounted rectangular speakers, 304mm length x 223mm width x 80mm depth. 35W RMS
1	SWSPK04	Pair of outdoor speakers, 130 x 105 x 170mm, 30W RMS, 1.8kg each. Available in black and white
1	SWST04	4 way spring loaded speaker terminal mounted on a standard plate.



Pack	Cat No	Single input distributed audio system
1	SWAM04	Audio distributor. 1 input, up to 4 outputs (5W per channel) 12V dc at 3.5A. Requires power supply.
1	SWVC02	60W wall mounted volume controller. Controls volume of outputs from audio distributor SWAM04. Mounted on Excel Standard WE or BL plate.



Pack	Cat No	Security cameras
1	SWSC02	Indoor/outdoor security camera



Pack	Cat No	Multi input distributed audio system
1	SWAM02	Audio distributor. 4 inputs, up to 4 outputs (10W per channel). 12Vdc at 7.0A. Requires power supply
1	SWVC03	Wall mounted digital volume controller. Controls volume of output from audio distributor SWAM02. With mute button, treble and bass adjustments, broadcast function. Remote control SWRC01 included. Excel style white plate.
1	SWRC01	Remote control for digital volume controller SWV03. Source select, volume adjustment and mute button.
1	SWAS01	Audio splitter, 4 inputs, 4 sets of outputs. 12Vdc at 0.5A. Requires power supply. 16 sets of RCA cables included.



Pack	Cat No	Modulators
1	SWMD01	Single channel mono modulator
1	SWMD03	3 channel modulator. Power pack, 3 sets of video and audio cables included



Pack	Cat No	Power supplies
1	SWPS005	Power supply 500mA Regulated 12V d.c. Plug-pack type
1	SWPS030	Power supply 3A. Regulated 12V d.c. Plug & lead supplied
1	SWPS050	Power supply 5A. Regulated 12V d.c. Plug & lead supplied
1	SWPS080	Power supply 8A. Regulated 12V d.c. Plug, lead and mounting bracket included
1	SWPL02	2 way power 12V d.c. split lead. Connects multiple modules to 3A, 5A, 8A power supplies
1	SWPSM01	DC power supply module 12V d.c. input - 2.5mm OD socket. 12V d.c. outputs - 1 x 4 pin 5.08mm pitch male connector, 3 x 2.5mm OD socket. 2 x 2.0mm OD socket



Pack	Cat No	Leads
1	SWLD003	Cat 5E data patch lead pack, 300mm long (Quantity 4)
1	SWLT003	Telephone patch lead pack, 300mm long (Quantity 4)
1	SWCBL01	Shielded Audio Cable Shielded 2 core audio cable. Black 100M per roll.

Audio system connections

Audio from up to 4 different sources can be delivered to up to 16* different zones of a home simultaneously. People in different rooms of a home can listen to different audio at the same time. So, you could be listening to the radio in the kitchen at the same time your children are listening to music in their bedrooms.

With all cabling hidden behind walls, the system is discreet. You can select the audio source you want to hear, adjust the volume, as well as treble and bass levels via the Audio Controllers.

In addition to distributing audio signals, the system has a broadcast function. By pressing the broadcast button on the **Audio Controller** you can communicate messages to people in other zones of your home.

* By using SWAS01 and three other SWAM02's.

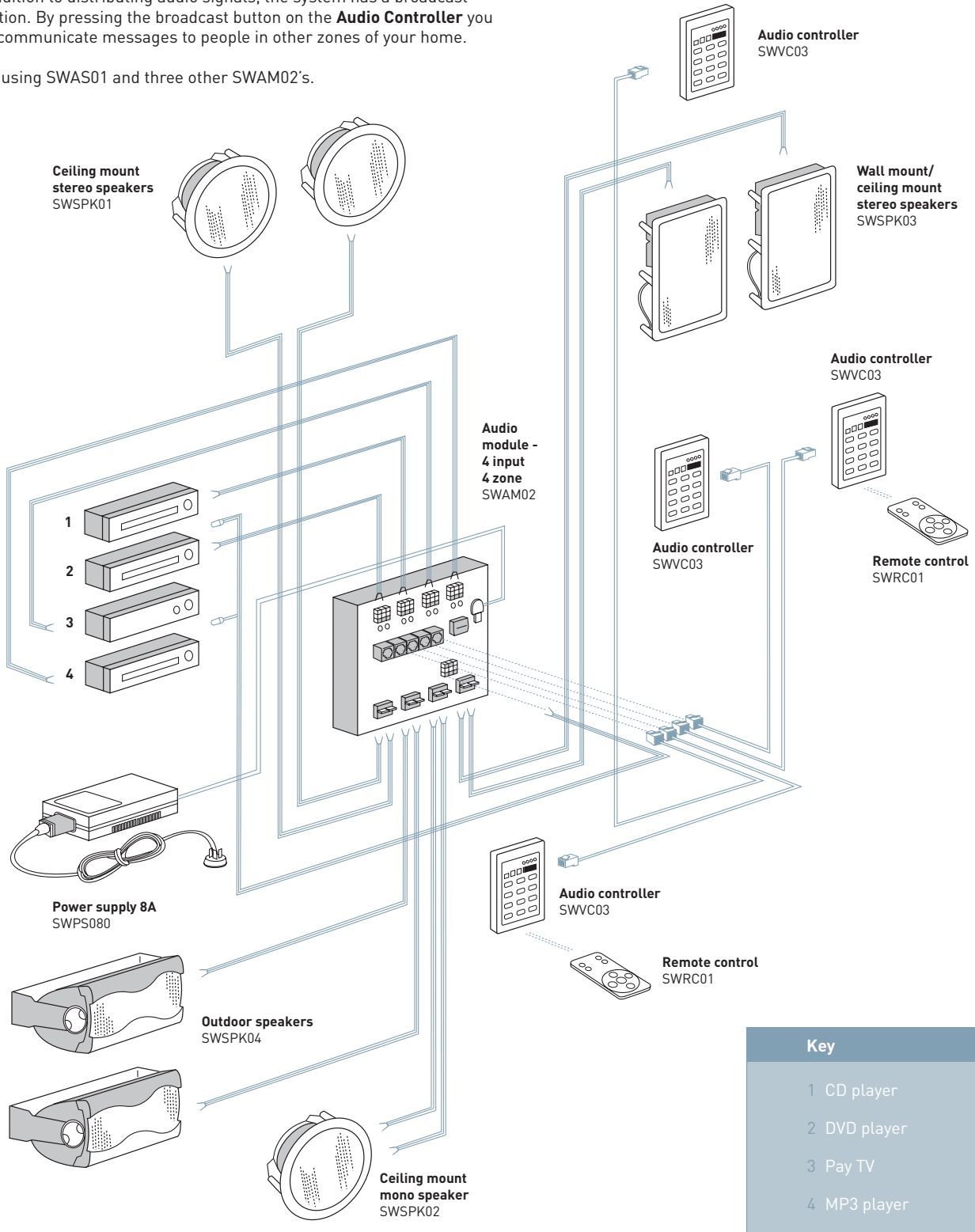

Key

- 1 CD player
- 2 DVD player
- 3 Pay TV
- 4 MP3 player

TV and security

DVD, VCR, security camera, Pay TV, and free-to-air TV signals can be distributed to up to six televisions via the Harmony™ Video combiner & splitter, and up to 8 televisions via the™ Advanced video combiner & splitter. A video recorder connected to either system can record material from free-to-air TV, Pay TV, DVD, or security cameras.

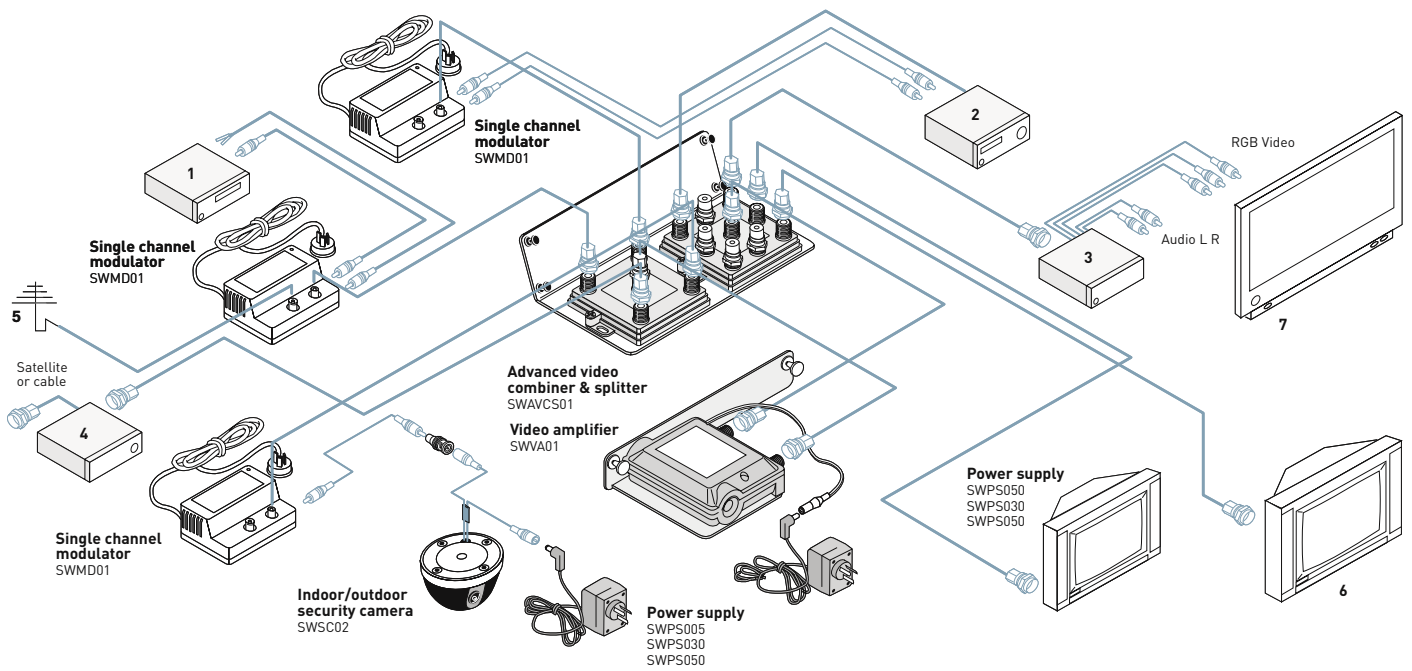

*Wiring is not limited to the sample shown, a typical representation only.

Key	
1	DVD player
2	VHS player
3	Digital set top box
4	Pay TV
5	Antenna
6	Conventional (CRT) television
7	Plasma screen television

IR control

You can have remote control to all of your audiovisual equipment in any room you choose with the Harmony™ infrared (IR) distribution system. Locate the Harmony™ IR emitter with your audio visual equipment, and the Harmony™ IR receivers in the locations where you want remote control. Connect both to the Harmony™ IR distributor.

The example illustrates an additional three locations where remote control of audiovisual equipment is possible. (Two where audio services can be accessed, including audio from Pay TV, free-to-air TV, DVD, and VCR and one where both audio and visual services can be accessed.)

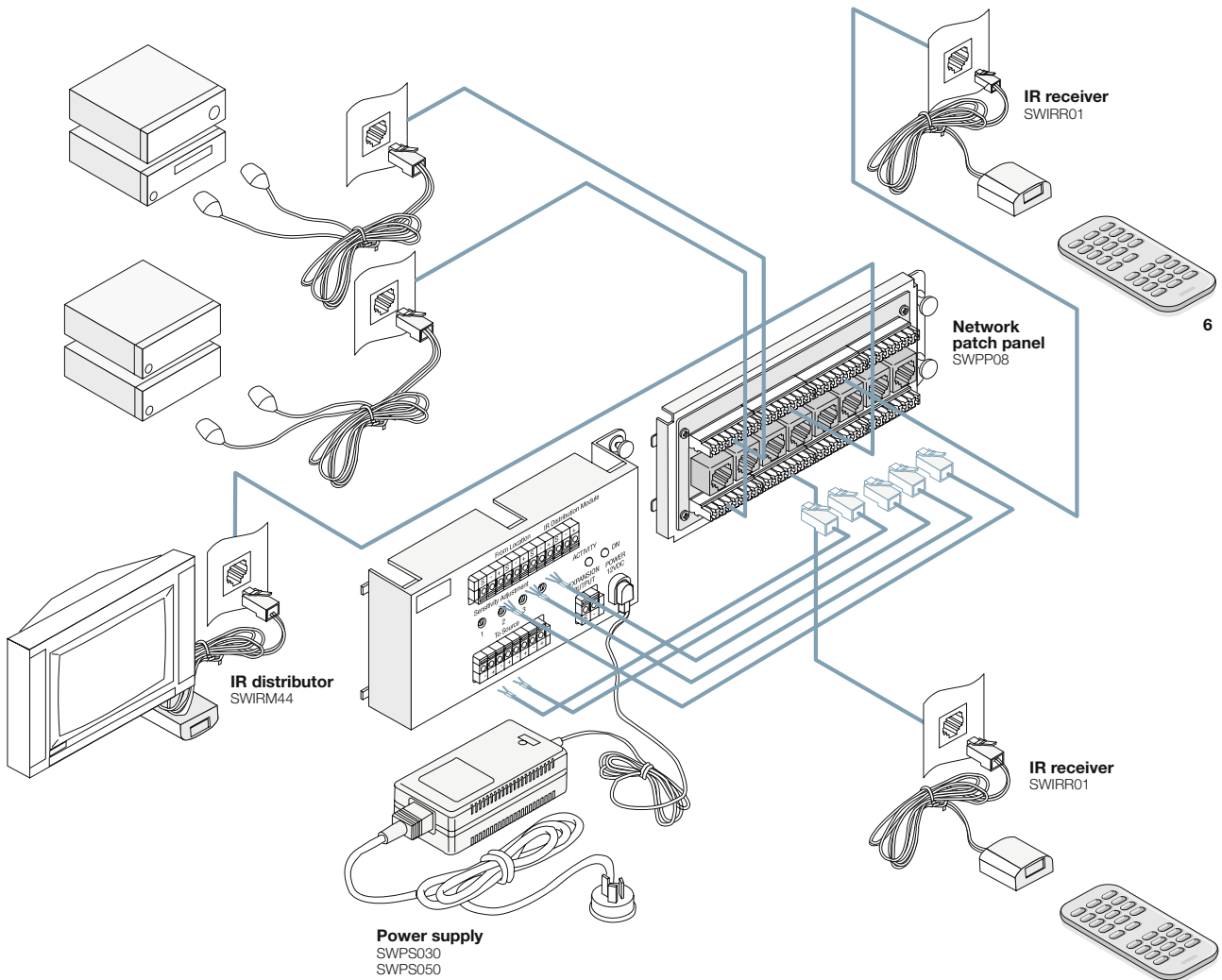

*Wiring is not limited to the sample shown, a typical representation only.

Key	
1	Tuner / amplifier
2	DVD player
3	VHS player
4	Pay TV
5	Television
6	Remote control

Data, Phone and Fax

With a Harmony™ Network patch panel and Network data hub, you can network your computer equipment just like you might find in an office environment. The computers can share data and peripherals such as printers, and modems.

The Harmony™ Advanced telephone distributor can be used to distribute up to 4 telephone lines to a maximum of 6 handsets. You can distribute a single line to multiple handsets, or multiple lines to handsets as desired. It is possible to have more than 4 inputs and 6 outputs with the purchase of additional modules.

Fax machines can operate on their own line, or they can be connected to telephone lines as illustrated in the diagram. The Harmony™ system includes a line-grabbing facility for security systems.

Key

- 1 Security system
- 2 Fax
- 3 Printer with network card
- 4 External lines (phone, fax and internet incoming lines)
- 5 Data modem

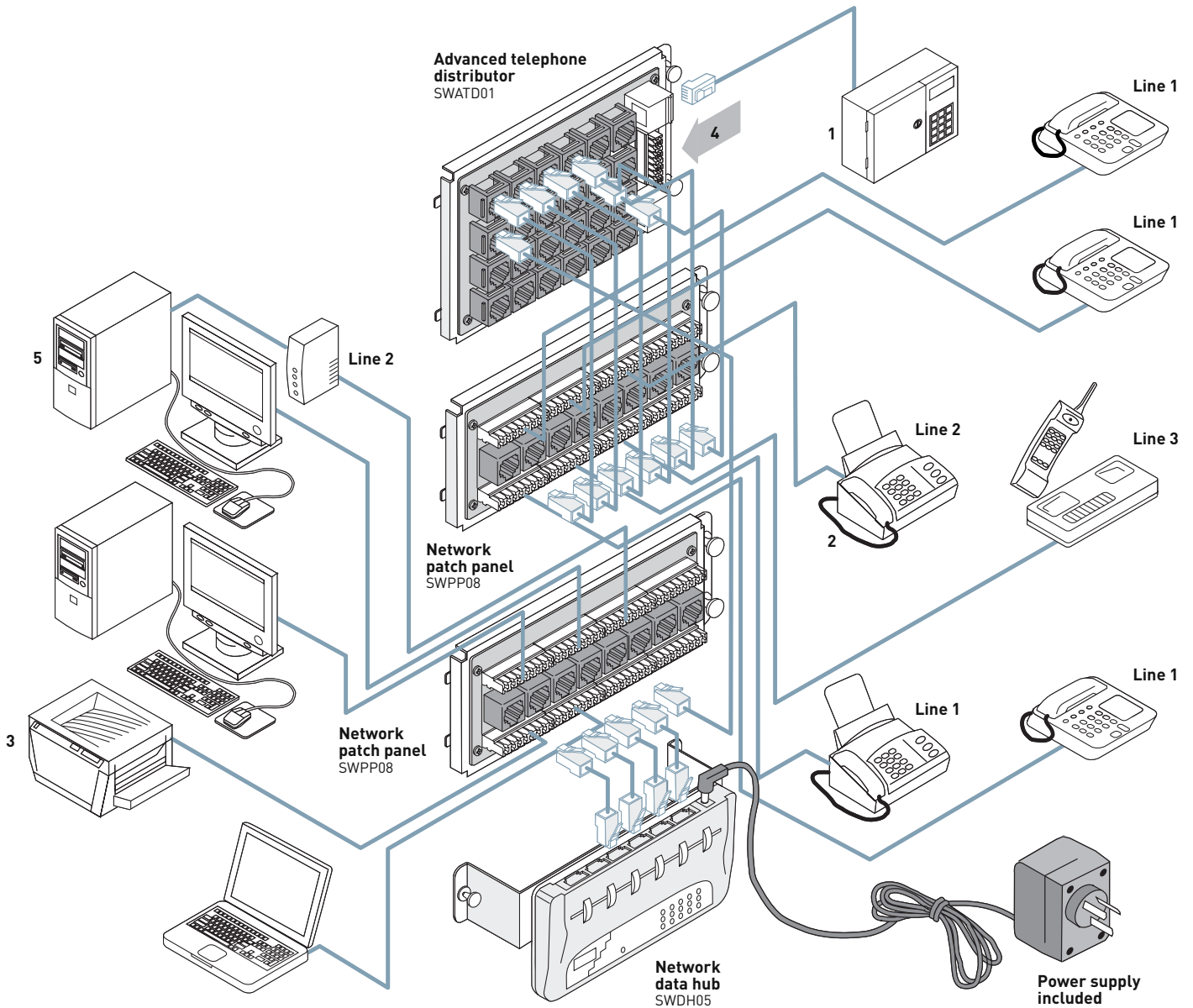

*Wiring is not limited to the sample shown, a typical representation only.